

Watercolor

FROM PHOTO TO WATERCOLOR

PHOTOSHOP ACTION

by Andrew Skoch

Watercolor from Photo - Photoshop Action

Hello! Thank you so much for purchase!

[Please rate this item here](#)

My name is Andrew Skoch. I'm graphic designer and [GRAPHICRIVER AUTHOR](#)

I tried to make super easy to use actions.

If you need any help please feel free to contact me through the contact form on [MY PAGE](#) or via email: andrewsko490@gmail.com

I will be happy for your comments and any feedback. It's always cool to see how my actions and mockups are used. So feel free to contact and show me your work.

Let's become friends!

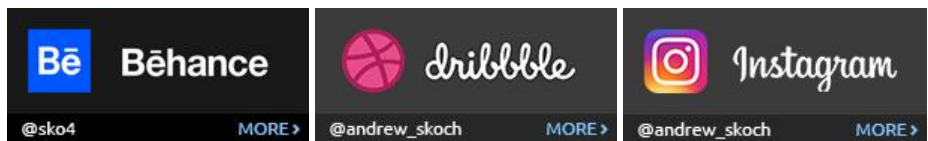

It's very easy to use this action:

1. Install action into your Photoshop:



Simply double-click (or drag and drop into your Photoshop) file **Watercolor from Photo Action [by Sko4].atn**

2. Install Brushes into your Photoshop:



Simply double-click (or drag and drop into your Photoshop) file **Watercolor Brushes [by Sko4].abr**

3. Install Pattern into your Photoshop:



Simply double-click (or drag and drop into your Photoshop) file **Watercolor Patterns [by Sko4].pat**

4. Open your image (Layers can be called by any names.)

5. Go to the actions palette

If the actions palette is not visible, go to “Window”, then click “Actions” in the dropdown

Find in Actions palette **Watercolor from Photo Action [by Sko4].atn**

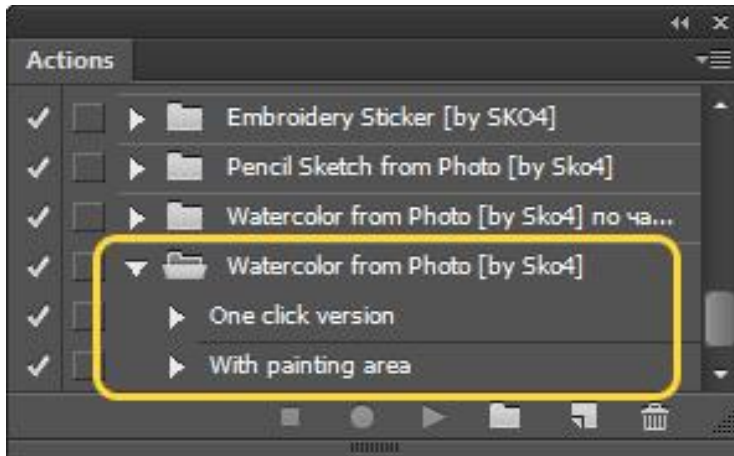

There are 2 versions of the same action:

What's the difference?

‘One click version’ is the simple way to use action. Just choose your photo in Layers panel and play action.

‘With painting area’ is action with possibility to choose area. Make new layer under you image, brush area and play action.

More details below.

6. One Click Version

Choose your photo in Layers panel. Layers can be called by any names.

Find **'One click version'** in Actions panel.

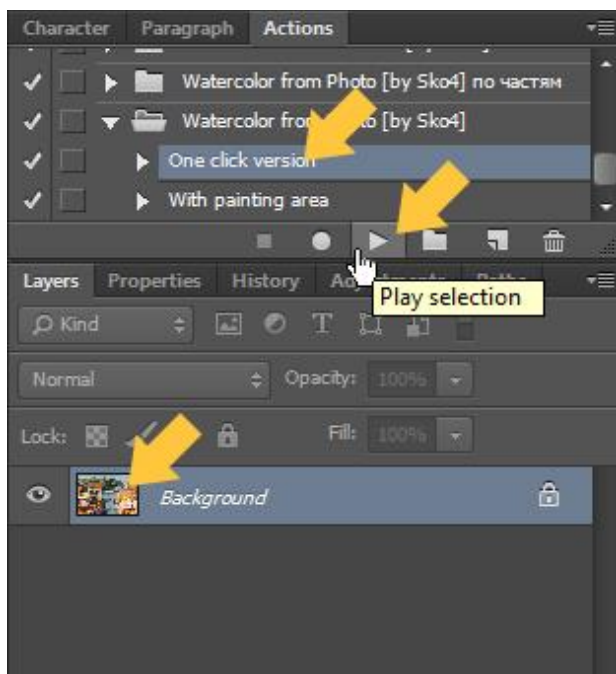
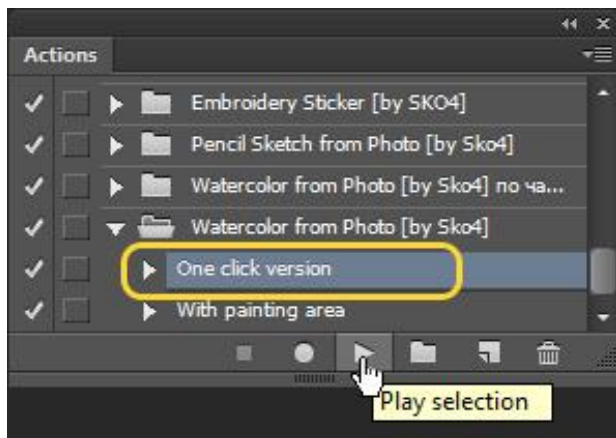

Click the 'Play' button and wait for the action to complete.

7. With painting area version

Create a new layer above the photo layer. Layers can be called by any names.

With the new layer selected, brush/trace the area. Leave this brush layer selected

Find **'With painting area'** in Actions panel.

Click the 'Play' button and wait for the action to complete.

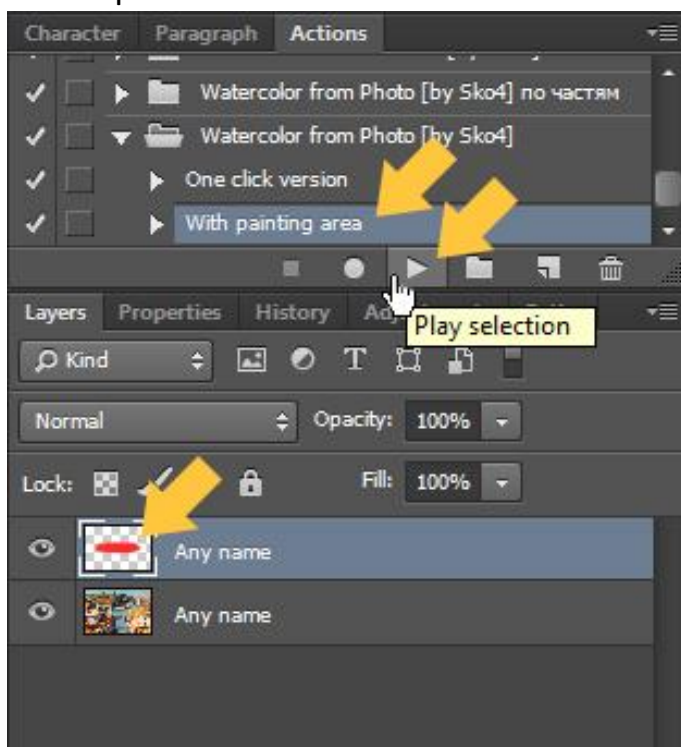

You can use action multiple times to get different results!



If you need any help please feel free to contact me through the contact form on [MY PAGE](#) or via email: andrewsko490@gmail.com

Enjoy results! And good luck with your projects!

- Andrew Skoch -