

Lightroom Classic Preset Installation

Start here – Lightroom Classic CC 7.3 | April 2018 or later

If you are using the latest version of Lightroom Classic CC 7.3 (April 2018) or later you need to locate this new folder where Camera RAW Presets are saved.

Presets format changed since this release to make them compatible in Camera Raw as well.

In order to find this folder, simply right click on **any** of the existing presets and choose Show in Finder or Open in Explorer

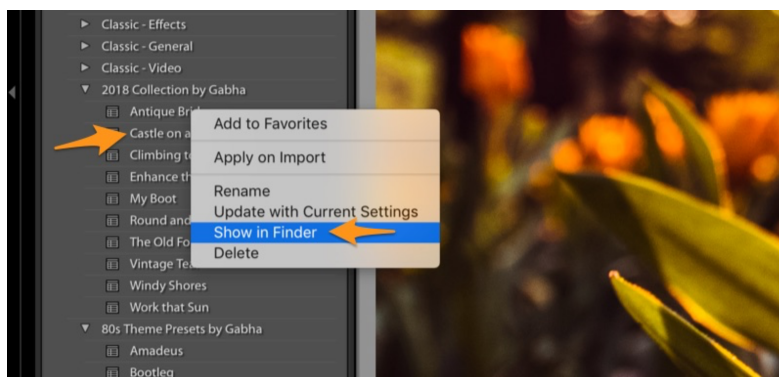

Next, go up one folder to the **Settings** folder.

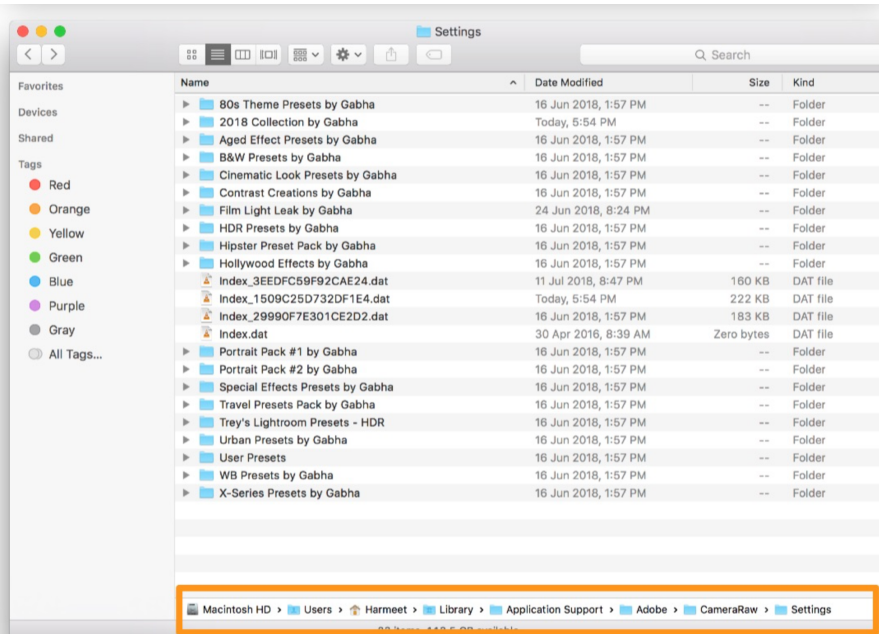

Start Here – Lightroom 6 or Classic CC 7.2 or earlier

Launch Lightroom and navigate to **Preferences** window. From the **Presets** tab, click on **Show Lightroom Preset Folder**.

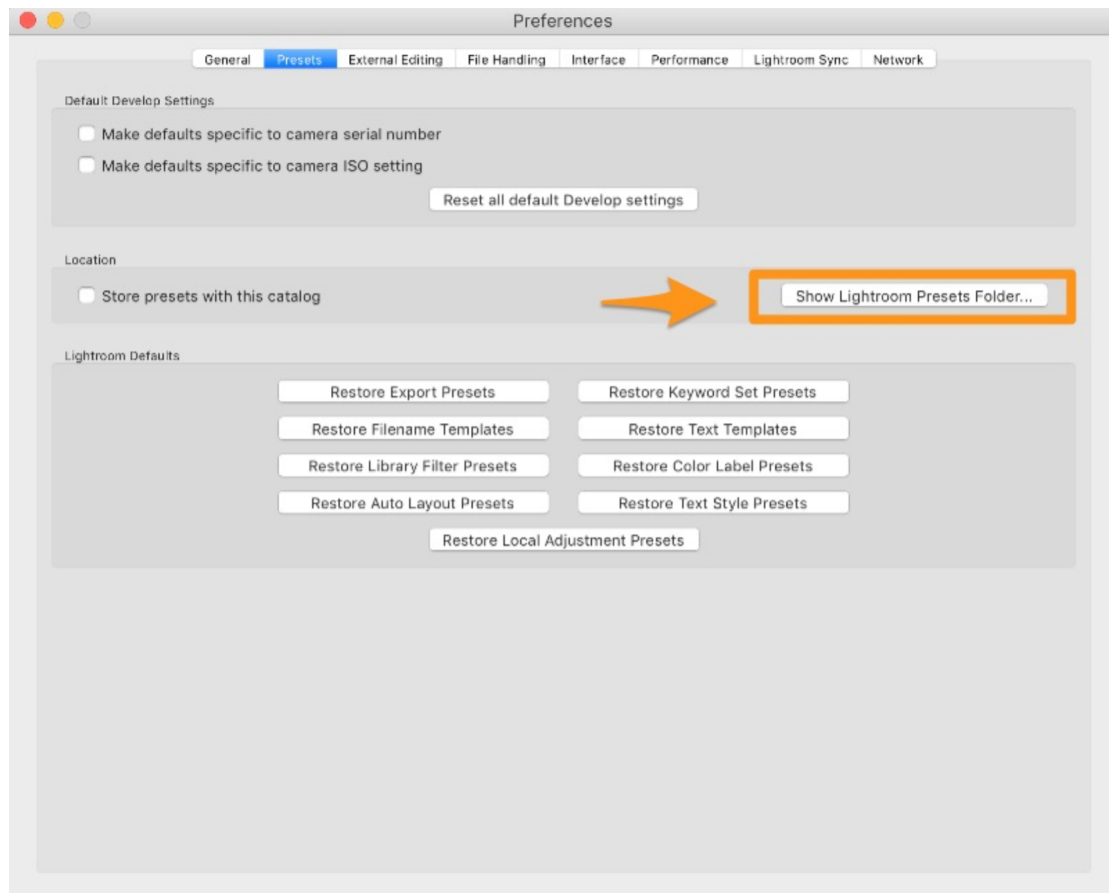

Double click on the **Develop Presets** folder

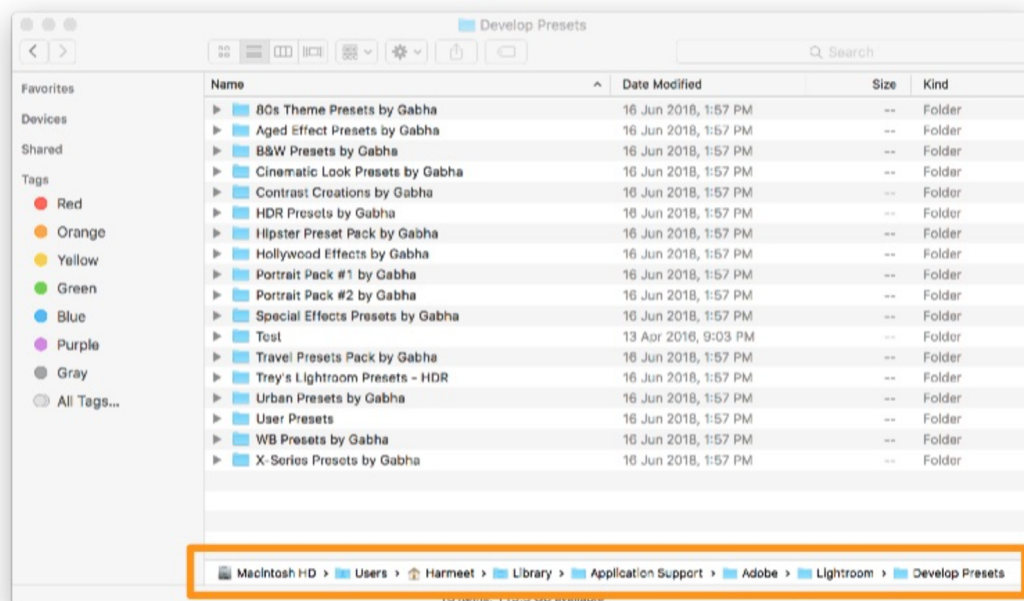

Installing the Presets

Assuming you have followed the above steps to navigate and locate your Presets folder on your computer.

You are now ready to install the presets.

Unzip the downloaded file(s) so you can see TWO folder within:

- “Install this for Lightroom Classic CC 7.3 - April 2018”
- “Install this for Lightroom Classic CC 7.2 or earlier”

Now **Open** the folder relevant to your version of Lightroom Classic, copy the contents into the presets folder that you located above.

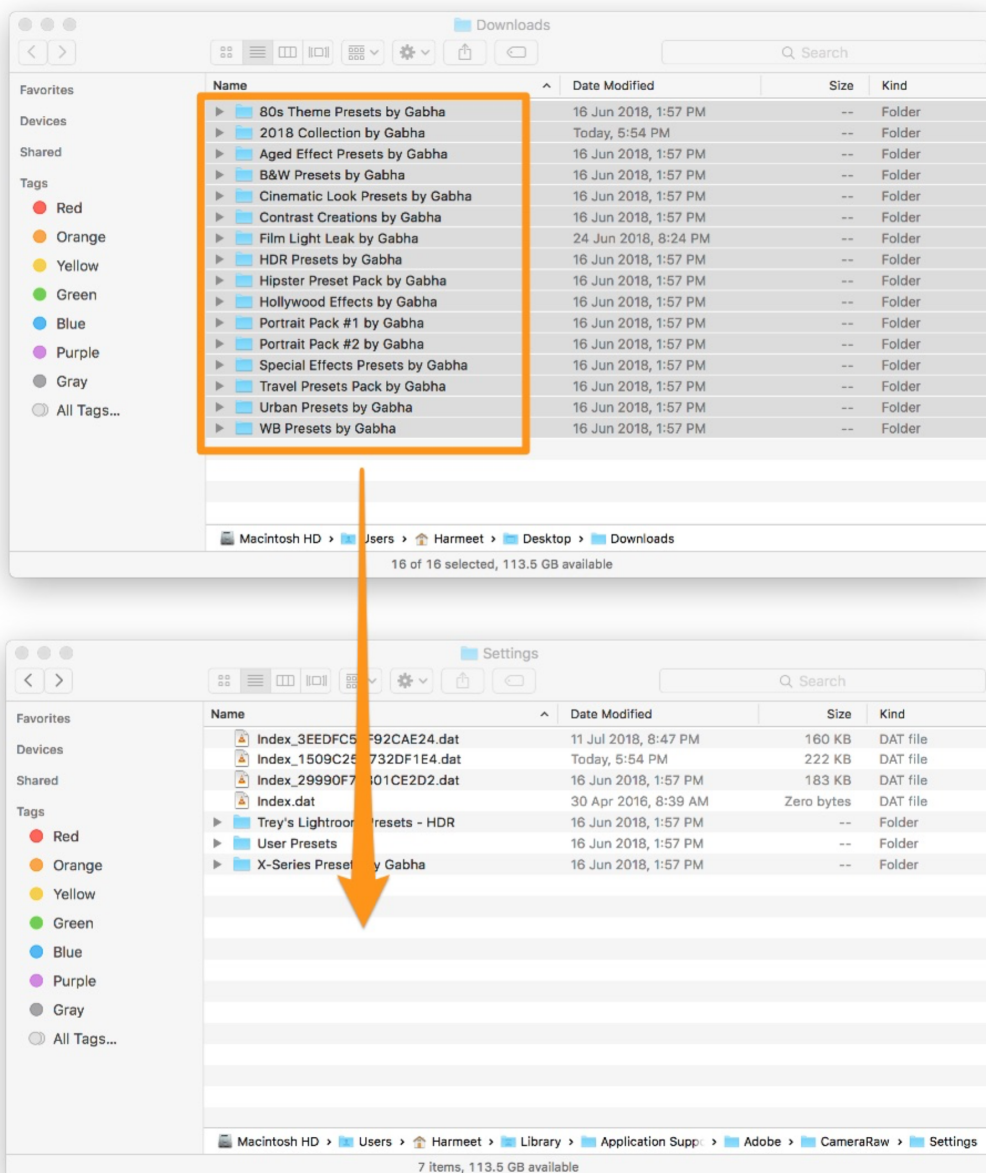

If Lightroom was running, close and restart it.

Help and Support

If you need any help please don't hesitate to contact me at harmeet@photoinsomnia.com

I'm based out of Sydney Australia so don't stress if you don't hear from me right away. I will get back to you asap.

Make sure you provide any details, like error messages or screenshots to help me understand your issue well.

Thoughts and Feedback

I'd also love to hear your thoughts and feedback on my presets. So don't hesitate to share your comments via harmeet@photoinsomnia.com