

INSTRUCTIONS

AN ARTIFEX FORGE TOOL KIT FOR ILLUSTRATOR



TURN YOUR DESIGNS INTO MESSY, AUTHENTIC
LOOKING SCREEN-PRINTS IN SECONDS!

THANKS FOR PURCHASING POSTER PRESS!

The pack contains 11 frame brushes and 12 ink texture patterns plus a quick reference guide.

These brushes and patterns have been bundled into a set 12 of one-click graphic styles which make it quick and easy for you to add them to your design. You can customize the look by creating your own pattern and frame combinations. The patterns and brushes can also be used separately.

PLEASE NOTE: This product is compatible with Illustrator CS5 - CC only and **WILL NOT** work in Photoshop or any earlier version of Illustrator.

Please see below for usage instructions or watch the tutorial video here - <https://vimeo.com/266126125>.

FINDING THE RIGHT FILE - IMPORTANT INFORMATION!

The information below will help you find the file that's compatible with your version of Illustrator.

The file name ending '..._CS5' works with Illustrator CS5 and CS6.

The file name ending '..._CC' works with Illustrator CC only.

USING THE GRAPHIC STYLES

TO LOAD THE GRAPHIC STYLES...

1. Open an Illustrator document.
2. Open the 'GRAPHIC STYLES TAB'. This can be found in the 'FILE>OPEN' menu if not already open.
3. In the tab's corner menu select 'OPEN GRAPHIC STYLE LIBRARY>OTHER LIBRARY...' and select one of the files from the downloaded product folder. The GRAPHIC STYLES will open in a new tab.
4. Click on any of the graphic style icons to transfer them to the main 'GRAPHIC STYLES TAB'. They will also be saved into your document.

It is important that you complete this step as it loads the brushes into the brushes tab and the texture patterns into the swatches tab. Which means that these elements can be used separately.

PLEASE NOTE: To access the quick reference guide simply open one of the files using the 'FILE>OPEN' menu. Because the graphic styles are white in colour the icons all look empty. Use the quick reference guide to identify each of the styles.

TO USE A GRAPHIC STYLE TO TURN A DESIGN INTO A SCREENPRINT...

- 1. Create a layer above your design.
- 2. Draw a rectangle using the ‘RECTANGLE TOOL’ roughly around the edge of your design.
- 3. With the rectangle selected click on one of the ‘GRAPHIC STYLE TAB’ icons and the frame and texture will appear over your design.
- 4. Adjust the frame brush width or colour or move or scale the texture to suit your design. Read on for how to do this.

Alternatively you can place your art on a lower layer, behind the quick reference guide examples and scale the examples to fit. Don’t forget to change the artboard size too!

TO CHANGE THE COLOR OF THE FRAME AND TEXTURE PATTERN TOGETHER...

- 1. Select the rectangle that has the screenprint applied effect.
- 2. Go to the ‘EDIT>EDIT COLORS>ADJUST COLOR BALANCE’ menu.
- 3. Choose a ‘COLOR MODE’.
- 3. Click the ‘CONVERT’ box as show below then adjust the color values until you are happy with the result.

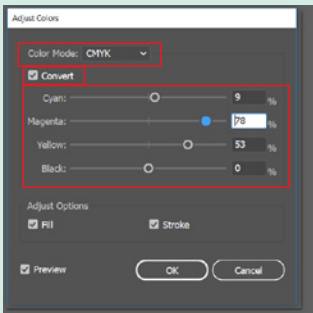

- 4. Click ‘OK’.

Please note: a new texture pattern swatch will be created when you do this. You’ll find it in the ‘SWATCHES TAB’.

USING THE FRAME BRUSHES SEPARATELY

TO APPLY A FRAME BRUSH TO A VECTOR SHAPE...

- 1. Making sure the brushes are loaded, select a vector shape using the ‘SELECTION TOOL’.
- 2. Click one of the ‘BRUSH TAB’ icons and the brush will be applied.

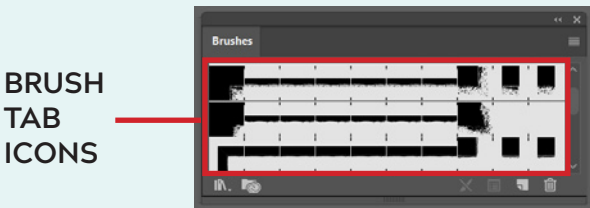

You can also use this technique to swap brushes if you already have a brush applied to a shape.

TO CHANGE THE COLOR OF THE FRAME BRUSH...

- 1. Select the rectangle which has a frame brush applied to it.
- 2. Open the ‘COLOR MENU’.
- 3. Select the ‘STROKE COLOR’.
- 4. Set the color values as desired by moving the sliders or changing the percentage values.

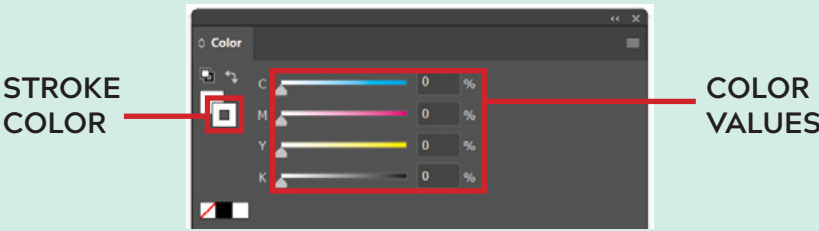

TO ADJUST THE THICKNESS OF YOUR FRAME BRUSH...

- 1. Select a rectangle which has a frame brush applied to it.
- 2. Open the ‘STROKE TAB’. This can be found in the ‘WINDOW MENU’.
- 2. Adjust the stroke weight as shown below. A higher number will result in a thicker frame and the lower number a thinner frame.

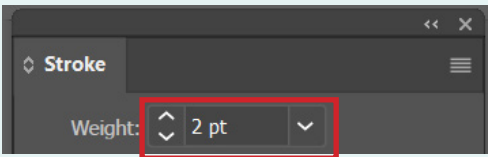

USING THE TEXTURE PATTERNS INDEPENDENTLY

TO APPLY A TEXTURE PATTERN...

1. Making sure the patterns are loaded, select a vector shape using the ‘**SELECTION TOOL**’.
2. Click one of the ‘**SWATCHES TAB**’ icons and the style will be applied.

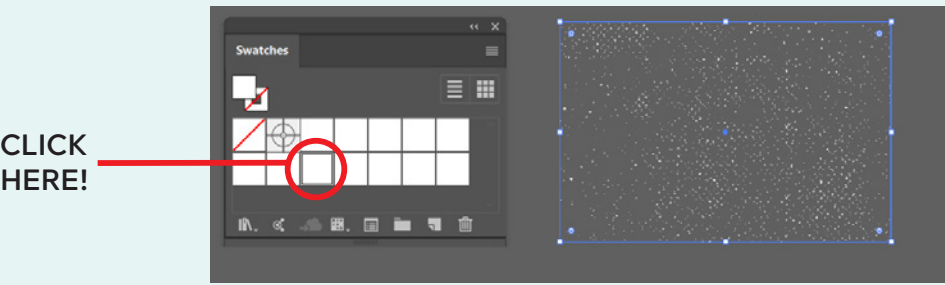

3. To switch to another pattern simply click on another swatch.

PLEASE NOTE: The pattern swatches are colored white so will look like they’re empty.

TO SCALE THE PATTERNS...

1. To scale the pattern independently of the container, access the ‘**OBJECT > TRANSFORM > SCALE...**’ menu
2. Set the tick boxes as per the screen-grab below, choose a percentage and click ‘**OK**’.

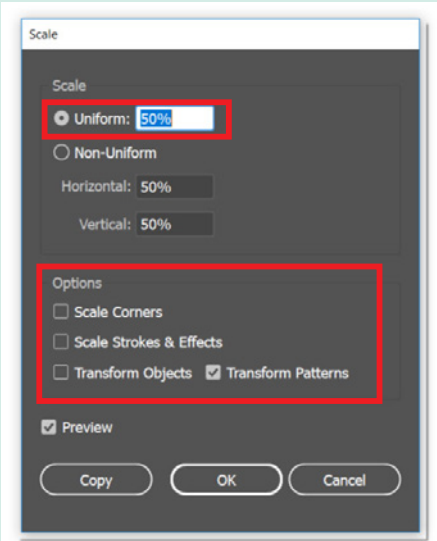

You can use this same function to scale the object independently of the pattern by ticking the ‘**TRANSFORM OBJECTS**’ box only

TO ROTATE THE PATTERNS INDEPENDENTLY OF THEIR CONTAINER...

1. Select an object with an applied pattern.
2. Select the ‘**OBJECT>TRANSFORM>ROTATE**’ menu and a new menu will appear.
3. Set the tick boxes as per the image below, type your desired angle in the box and click ‘**OK**’.

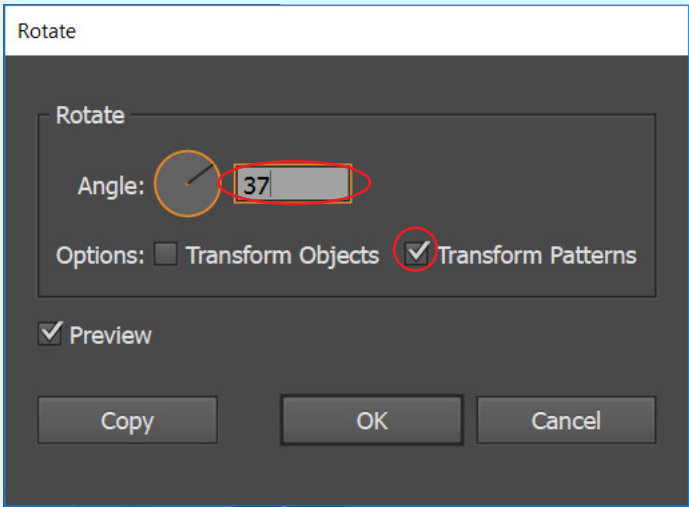

TO MOVE THE TEXTURE PATTERN WITHIN IT'S CONTAINER...

1. Select an object with an applied pattern.
2. Using the selection tool hold the '⌘' key (if you are on a Mac) or, '⌥' key (if using a PC) and drag your cursor.

TO ADJUST THE TEXTURE PATTERN COLORS...

1. Select an object with an applied pattern.
2. Access the 'EDIT>EDIT COLORS>ADJUST COLOR BALANCE' menu.
3. Select your desired 'COLOR MODE' and tick the 'CONVERT' box.
4. Adjust the color value sliders (as highlighted in red below) until you're happy with the outcome.

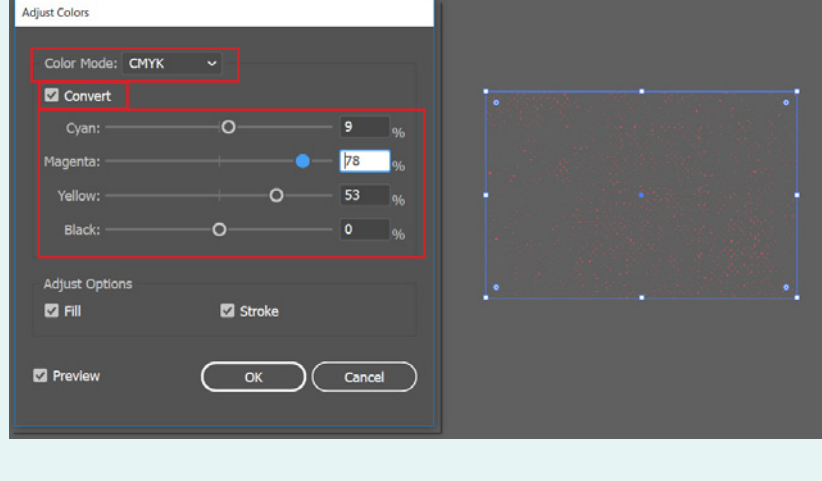

1. Click 'OK' to confirm the change. A new swatch featuring the new color will appear in the 'SWATCHES TAB'.

USEFUL TIPS AND HINTS

Use the texture overlays liberally and don't swamp your image with texture.

If the texture looks too heavy try adjusting the opacity of the pattern overlays. This will soften the effect

Try layering multiple texture overlays.

Use in combination, a white texture layer and another texture that uses a darker colour from your design.

Add round corners to your frame for a vintage polaroid look.

GET IN TOUCH!

Contact me at support@artifexforge.com

I'd love to see what you create using my add-ons so why not get in touch?

Tag me on Instagram if you post anything that uses one of my products - @theartifexforge

If you have any problems please contact me before leaving negative feedback - I will always do my best to get the product working for you.

GET FREE PRODUCTS when you sign up to my mailing list [HERE](#)

